





## 60 Lucknow Drive, Mapperley Park

£380,000

🛏 4 🚿 1 🛋 2

- Detached Bungalow
- Popular Location
- In Need of Refurbishment
- Entrance Hall
- Lounge
- Dining Room
- Kitchen
- Four Bedrooms
- Bathroom with Separate WC
- Integral Garage – Approx. 21'4 x 14'6



This charming property is in the highly sought-after Mapperley Park conservation area, renowned for its character and beauty. Positioned on one of the areas most desirable roads this detached bungalow offers an exceptional opportunity for those seeking a project. Just 3 miles from the City Centre, the property provides easy access to a wide range of amenities. The property needs refurbishment, making it the perfect project. It features a sizable integral garage and ample living space, including an entrance hall, lounge, dining room, kitchen, four bedrooms, and a bathroom with separate WC. Sitting on an expansive plot, the property boasts an elevated position offering stunning views of the surrounding area. The driveway provides off-road parking, whilst the large integral garage offers ample storage space and the potential for additional accommodation.



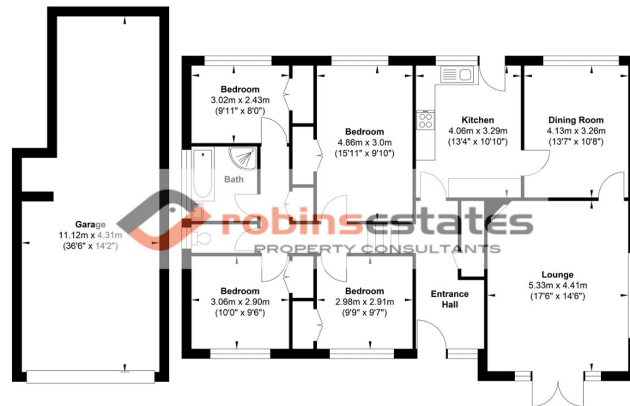

Lower Ground Floor

Ground Floor

Gross Internal Floor Area : 165.8 m2 ... 1784.8 ft2

Whilst every attempt has been made to ensure the accuracy of the floor plan contained here, measurements of doors, windows, rooms and any other items are approximate and no responsibility is taken for any error, omission, or mis-statement. This plan is for illustrative purposes only and should be used as such by any prospective purchaser. The services, systems and appliances shown have not been tested and no guarantee as to their operability or efficiency can be given.



**Give Erica or Angela a call on 0115 8240235**

Email us: [enquiries@robinsestates.com](mailto:enquiries@robinsestates.com)

5 Derby Terrace, Derby Road, Nottingham, NG7 1ND

